





LED Description

Function/ LED Color	OFF	ON	BLINKING
LINE	N / A	N / A	N / A
	Bridged mode or no xDSL connection	Line connected. IP address received from IPCP or DHCP. VX interface is up. No IP traffic detected	Connected line and In/Out IP traffic over the WAN
	WIRELESS interface is down	WIRELESS service activated	In/Out WIRELESS IP traffic
ETH1	No device connected	Ethernet device connected to the port	In/Out IP traffic on the WAN
ETH0 1, 2, 3, 4	No device connected	Ethernet device connected to the port	In/Out IP traffic on the LAN
FXS 1, 2, 3, 4	Line unregistered to the SIP server	Line registered to the SIP server	N / A
BRI 1, 2, 3, 4	Line unregistered to the SIP server	Line registered to the SIP server	N / A
POWER	CPE turned off	CPE turned on, completed startup	N / A
		Startup phase or failed initialization	N / A

LED Colors are: Green and Red

CPE: Customer Premises Equipment

Note: VX interface does not have a LED

Connectors, Pin-out, Cables

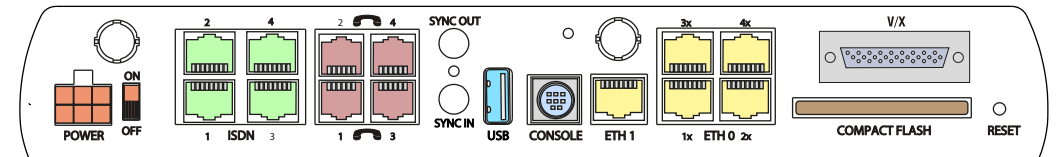

Interface	Description	Connector	Functionality
V/X	VX	Sub-D 26 pin	VX Multiprotocol Serial
Console	Console	MiniDIN 8P	RS232 Local Management
FE	Eth0, Eth1	RJ45	LAN, WAN
ISDN	BRI1-4	RJ45	TE or NT for ISDN PABX Connection
FXS	FXS1-4	RJ11	Analog TE Connection

RJ 45 Pin - out

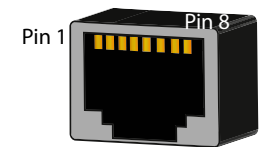

BRI ISDN Ports	FE Ports
----------------	----------

Pin 1,2,7,8:	Non connected	Pin 1:	White orange
Pin 3:	Rx (+)	Pin 3:	White green
Pin 4:	Tx (+)	Pin 4:	Blu
Pin 5:	Tx (-)	Pin 5:	White blu
Pin 6:	Rx (-)	Pin 6:	Green
		Pin 7:	White brown
		Pin 8:	Brown

FXS Ports	RJ11 Pin - out
-----------	----------------

Pin 1,2,5,6	Non connected
Pin 3,4	Connected

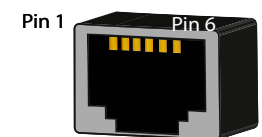

V/X Port

Interface	Aethra code Cable Adaptors
V.11/X.21	506G17659
V.35	506G17655
RS449 (V.36)	506G17657

V/X interface is used as DTE through optional cable adaptors to support V.35, V.11/X.21 and RS449 (V.36) standards

BRI ISDN Cable straight NT configuration

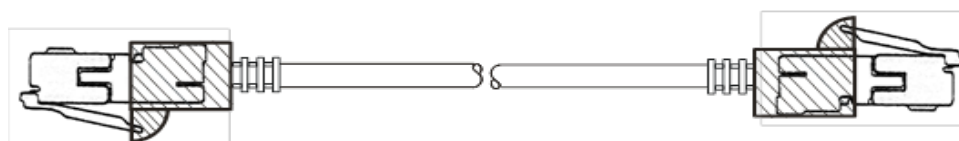
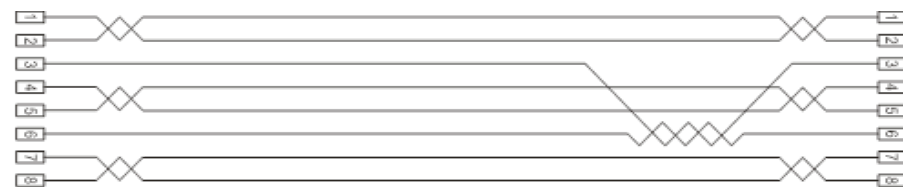

BRI ISDN Cable cross TE configuration

